

Hypogean & Shuays

Inground fixtures for landscape as well as underwater applications manufactured with high quality stainless steel 316 grade in round and linear profiles



Project - Welcomhotel by ITC
Bhubhneswar, India

Hypogean - Features

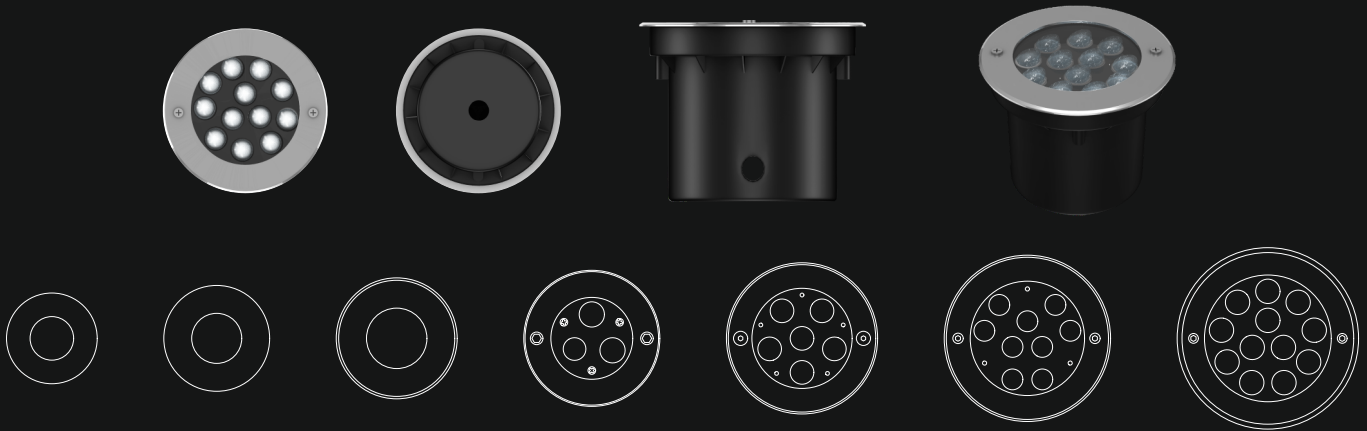

- 7 Sizes in Fixed & 1 Size in Tilt Versions
- Multiple Beam Angle Options
- IP67 Rated Fixtures
- Separate Back Box Mounting
- SS 316 Non-corrosive Material
- Loop-in Loop-out with Custom Cable Length

Hypogean Linear - Features



- 4 Sizes
- Multiple Beam Angle Options
- IP67 Rated Fixtures
- Separate Back Box Mounting
- SS 316 Non-corrosive Material
- Loop-in Loop-out with Custom Cable Length

Shuyas (Underwater) - Features

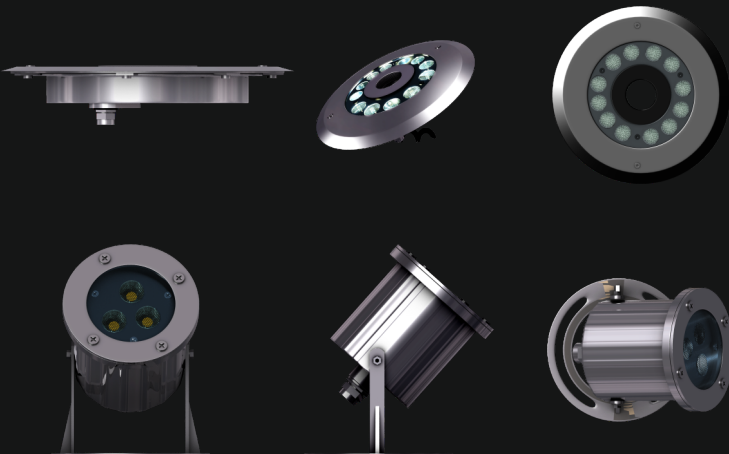

- 7 Sizes in Recessed Version
- Surface & Fountain Nozzle Version
- Multiple Beam Angle Options
- IP68 Rated Fixtures
- Separate Back Box Mounting
- SS 316 Non-corrosive Material
- Loop-in Loop-out with Custom Cable Length

Hypogean

LED	Typ CRI	Trim Finish	Voltage	IP / IK Rating	Dimming Options	Filter Options
High Power 3 Step MacAdam L90-B10 60,000Hrs	92	SS	AC230V DC24V	IP67 IK08	Non Dim Triac Analog Dali 	Honeycomb

Hypogean Tilt

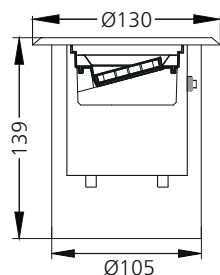
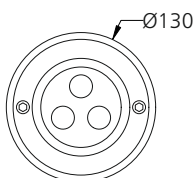

RA-3
#3042

Hypogean Fix

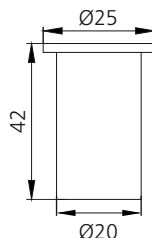
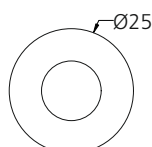

Micro
#3034

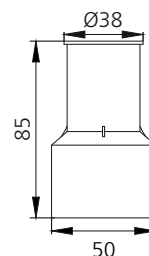
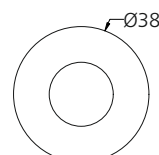

Mini
#3035

Power	6W/9W
Lumen / CCT	470lm/705lm - 2700K 480lm/725lm - 3000K 255lm/385lm - Red 415lm/620lm - Green 215lm/325lm - Blue
UGR	<19
Beam Angle	10° 15° 30° 45° 60°
Driver	In-built - AC230V
Placement	Remote - DC24V

Power	1W
Lumen / CCT	73lm - 2700K 75lm - 3000K
UGR	<19
Beam Angle	15° 30° 45° 60°
Driver	Remote - DC24V

Power	1W/3W
Lumen / CCT	73lm/218lm - 2700K 75lm/223lm - 3000K 36lm/110lm - Red 62lm/185lm - Green 29lm/87lm - Blue
UGR	<19
Beam Angle	8° 15° 30° 45° 60°
Driver	Remote - DC24V

Hypogean

LED	Typ CRI	Trim Finish	Voltage	IP / IK Rating	Dimming Options	Filter Options
High Power 3 Step MacAdam L90-B10 60,000Hrs	92	SS	AC230V DC24V	IP67 IK08	Non Dim Triac Analog Dali 	Honeycomb

Hypogean Fix

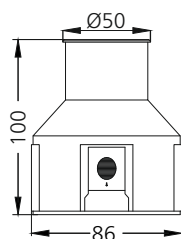
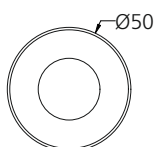

R1
#3036

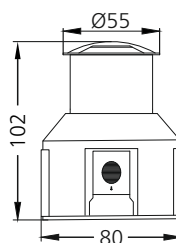
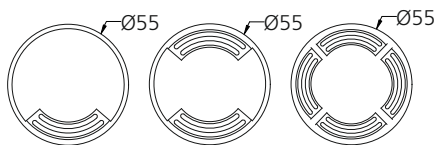

Rc3
#3038

Power	1W/3W	3W
Lumen / CCT	79lm/235lm - 2700K 81lm/241lm - 3000K 43lm/128lm - Red 69lm/205lm - Green 35lm/106lm - Blue	190lm - 2700K 195lm - 3000K
UGR	<19	<19
Beam Angle	8° 15° 30° 45° 60° Asy	60x1° 60x2° 60x4°
Driver Placement	In-built - AC230V Remote - DC24V	In-built - AC230V Remote - DC24V

Hypogean

LED	Typ CRI	Trim Finish	Voltage	IP / IK Rating	Dimming Options	Filter Options
High Power 3 Step MacAdam L90-B10 60,000Hrs	92	SS	AC230V DC24V	IP67 IK08	Non Dim Triac Analog Dali 	Honeycomb

Hypogean Fix

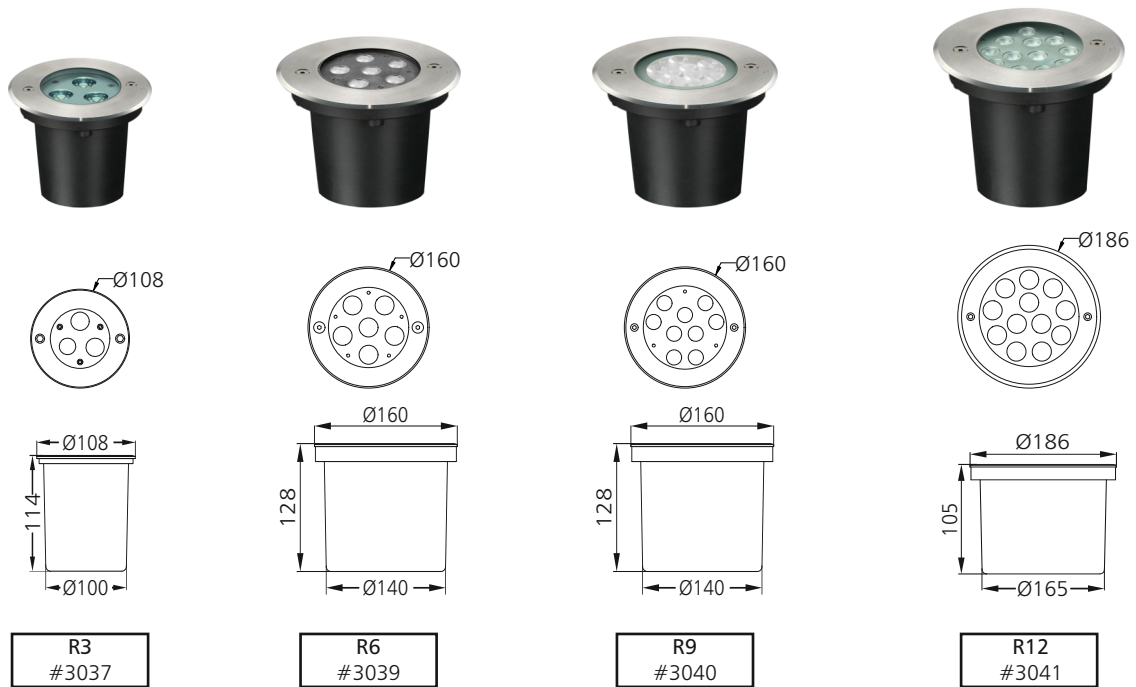

	R3 #3037	R6 #3039	R9 #3040	R12 #3041
Power	6W/9W	6W/12W	9W/18W	12W/24W
Lumen / CCT	470lm/705lm - 2700K 480lm/725lm - 3000K 255lm/385lm - Red 415lm/620lm - Green 215lm/325lm - Blue	470lm/940lm - 2700K 480lm/965lm - 3000K 255lm/515lm - Red 415lm/825lm - Green 215lm/430lm - Blue	705lm/1415lm - 2700K 725lm/1450lm - 3000K 385lm/775lm - Red 620lm/1245lm - Green 325lm/650lm - Blue	940lm/1885lm - 2700K 965lm/1930lm - 3000K 515lm/1030lm - Red 825lm/1655lm - Green 430lm/865lm - Blue
UGR	<19	<19	<19	<19
Beam Angle	8° 15° 30° 45° 60° Asy	8° 15° 30° 45° 60° Asy	8° 15° 30° 45° 60° Asy	8° 15° 30° 45° 60° Asy
Driver Placement	In-built - AC230V Remote - DC24V	In-built - AC230V Remote - DC24V	In-built - AC230V Remote - DC24V	In-built - AC230V Remote - DC24V



Project - Saptha Resort & Spa
Kerala, India

Hypogean

LED	Typ CRI	Trim Finish	Voltage	IP / IK Rating	Dimming Options	Filter Options
High Power 3 Step MacAdam L90-B10 60,000Hrs	92	SS	DC24V	IP67 IK08	Non Dim Triac Analog Dali 	Honeycomb

Hypogean Linear

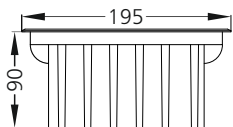
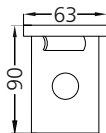

Linear S
#3046

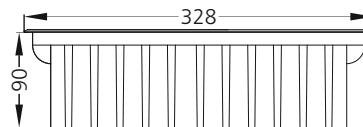
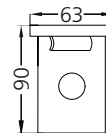

Linear M
#3047

Power	3W/6W	6W/12W
Lumen / CCT	255lm/505lm - 2700K 261lm/520lm - 3000K 145lm/290lm - Red 222lm/445lm - Green 123lm/245lm - Blue	505lm/1015lm - 2700K 520lm/1040lm - 3000K 290lm/580lm - Red 445lm/890lm - Green 245lm/490lm - Blue
UGR	< 19	< 19
Beam Angle	8° 15° 30° 45° 10x60° Asy	8° 15° 30° 45° 10x60° Asy
Driver Placement	Remote - DC24V	Remote - DC24V

Hypogean

LED	Typ CRI	Trim Finish	Voltage	IP / IK Rating	Dimming Options	Filter Options
High Power 3 Step MacAdam L90-B10 60,000Hrs	92	SS	DC24V	IP67 IK08	Non Dim Triac Analog Dali 	Honeycomb

Hypogean Linear

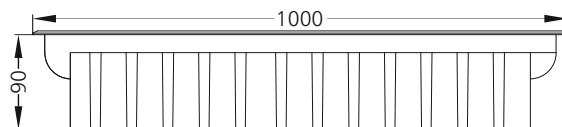
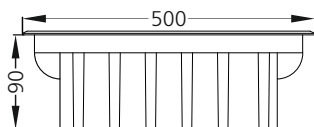
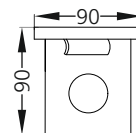
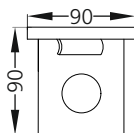
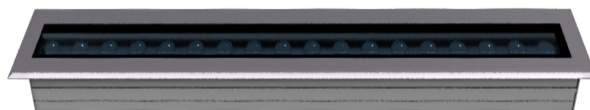
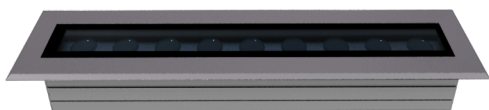

Linear L
#3048

Linear XL
#3049

Power	12W/24W	24W/48W
Lumen / CCT	1015lm/2030lm - 2700K 1040lm/2080lm - 3000K 580lm/1160lm - Red 890lm/1780lm - Green 490lm/980lm - Blue	2030lm/4055lm - 2700K 2080lm/4155lm - 3000K 1160lm/2320lm - Red 1780lm/3560lm - Green 980lm/1955lm - Blue
UGR	<19	<19
Beam Angle	8° 15° 30° 45° 10x60° Asy	8° 15° 30° 45° 10x60° Asy
Driver Placement	Remote - DC24V	Remote - DC24V



Project - Hotel Hawthorn by Wyndham
Dwarka, India

Shuays

LED	Typ CRI	Trim Finish	Voltage	IP / IK Rating	Dimming Options	Filter Options
High Power 3 Step MacAdam L90-B10 60,000Hrs	92	SS	DC24V	IP68 IK08	Non Dim Triac Analog Dali 	NA

Shuays

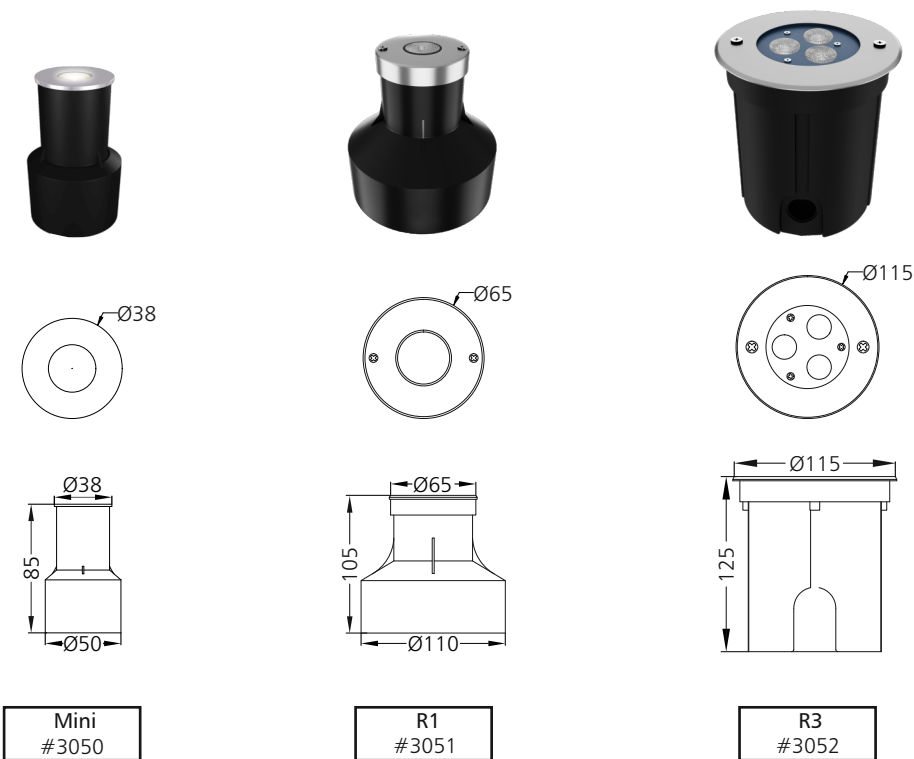

	Mini #3050	R1 #3051	R3 #3052
Power	1W/3W	1W/3W	6W/9W
Lumen / CCT	90lm/270lm - 3000K	90lm/270lm - 3000K 51lm/153lm - Red 77lm/231lm - Green 44lm/132lm - Blue	540lm/805lm - 3000K 305lm/460lm - Red 460lm/695lm - Green 265lm/395lm - Blue
UGR	<19	<19	<19
Beam Angle	8° 15° 30° 45° 60°	8° 15° 30° 45° 60° 90° Asy	8° 15° 30° 45° 60° 90° Asy
Driver Placement	Remote - DC24V	Remote - DC24V	Remote - DC24V

Shuays

LED	Typ CRI	Trim Finish	Voltage	IP / IK Rating	Dimming Options	Filter Options
High Power 3 Step MacAdam L90-B10 60,000Hrs	92	SS	DC24V	IP68 IK08	Non Dim Triac Analog Dali 	NA

Shuays

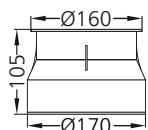
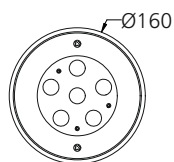
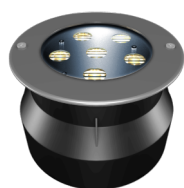

R6
#3053

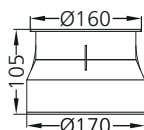
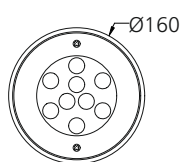

R9
#3054

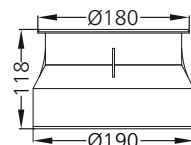
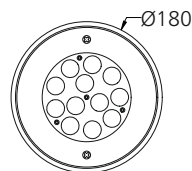

R12
#3055

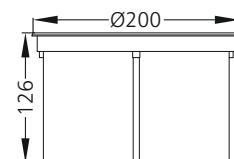
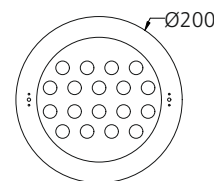

R18
#3056

Power	12W/18W	18W/27W	24W/36W	36W/54W
Lumen / CCT	1075lm/1615lm - 3000K 610lm/920lm - Red 925lm/1385lm - Green 530lm/790lm - Blue	1615lm/2420lm - 3000K 920lm/1375lm - Red 1385lm/2080lm - Green 790lm/1185lm - Blue	2150lm/3230lm - 3000K 1225lm/1835lm - Red 1845lm/2775lm - Green 1055lm/1585lm - Blue	3230lm/4845lm - 3000K 1835lm/2755lm - Red 2775lm/4160lm - Green 1585lm/2376lm - Blue
UGR	<19	<19	<19	<19
Beam Angle	8° 15° 30° 45° 60° 90° Asy	8° 15° 30° 45° 60° 90° Asy	8° 15° 30° 45° 60° 90° Asy	8° 15° 30° 45° 60° 90° Asy
Driver Placement	Remote - DC24V	Remote - DC24V	Remote - DC24V	Remote - DC24V

Shuays

LED	Typ CRI	Body Finish	Voltage	IP / IK Rating	Dimming Options	Filter Options
High Power 3 Step MacAdam L90-B10 60,000Hrs	92	SS	DC24V	IP68 IK07	Non Dim Triac Analog Dali 	NA

Shuays Surface

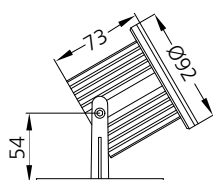
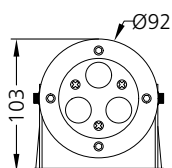

Surface S3
#3057

Shuays Fountain

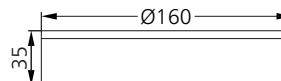
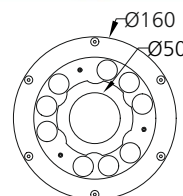

Fountain F9
#3060

Power	6W/9W	18W/27W
Lumen / CCT	540lm/805lm - 3000K 305lm/460lm - Red 460lm/695lm - Green 265lm/395lm - Blue	1615lm/2420lm - 3000K 920lm/1375lm - Red 1385lm/2080lm - Green 790lm/1185lm - Blue
UGR	< 19	< 19
Beam Angle	8° 15° 30° 45° 60° 90°	8° 15° 30° 45° 60° 90°
Driver Placement	Remote - DC24V	Remote - DC24V